

« *La Maison Crocheton* »

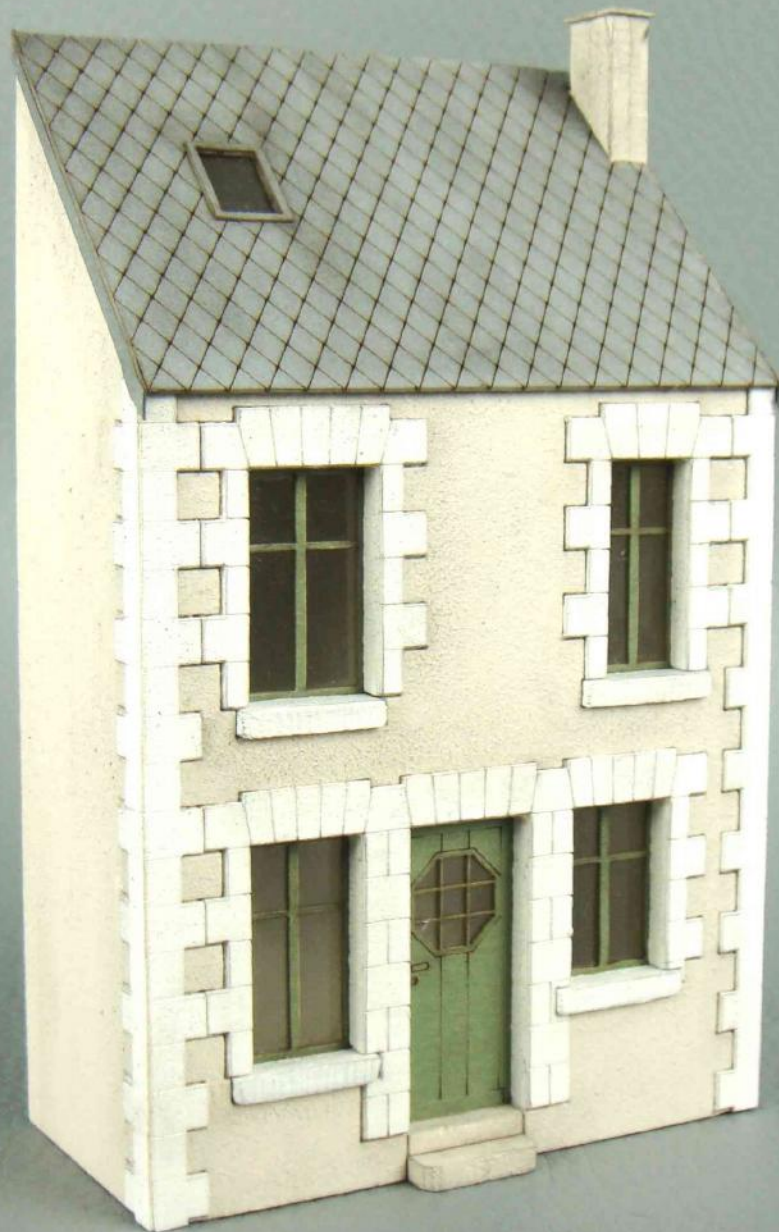

kit MN79
HO Scale
Dimensions: 6.5 x 3 x 10.5 cm
Laser-cut cardboard
Made in France

Minifer



Instructions available
on our website

25 Bis Chemin du Roy – Onzain
41150 VEUZAIN SUR LOIRE
contact@minifer.fr
<http://www.minifer.fr/>



Introduction

The model you have just purchased is a reproduction of a house located in Onzain (41).

Before starting, it is advisable to read this entire instruction booklet. Please note that some parts of this model and the use of sharp tools, glues and paints are not suitable for children under 12 unless accompanied by an adult.

Minifer thanks you for this purchase and wishes you a pleasant time building this model!

Recommended Tools and Materials

- precision cutter or scalpel
- tweezers
- nail file
- wood glue
- paintbrushes
- paints
- decorating clay



We insist on:



Wood glue is perfect for fixing everything. Apply with a toothpick. Available in DIY stores.



The fine-grain foam sponge mimics the render finish. Available in craft stores.



The following paints have been tested and are suitable for this model. Available in craft stores:

Liquitex Basics Acrylic

Titanium White:
Window surrounds & wall corners

Amsterdam Standard Series Acrylic

Dark Buff Titanium no.290:
Walls

Kit Contents

Walls 1 to 8, window sills 9, cladding panels 10 to 13, chimney caps 14–15, door & window frames 16 to 18, skylight surround 19, slates 20, roof edges 21

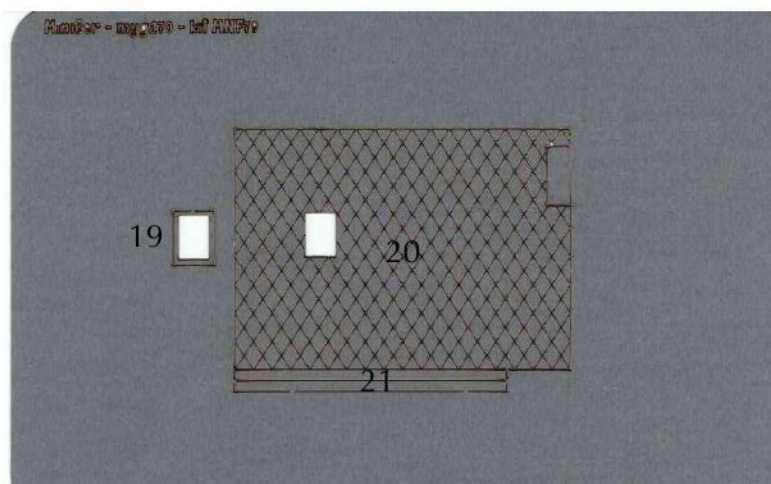
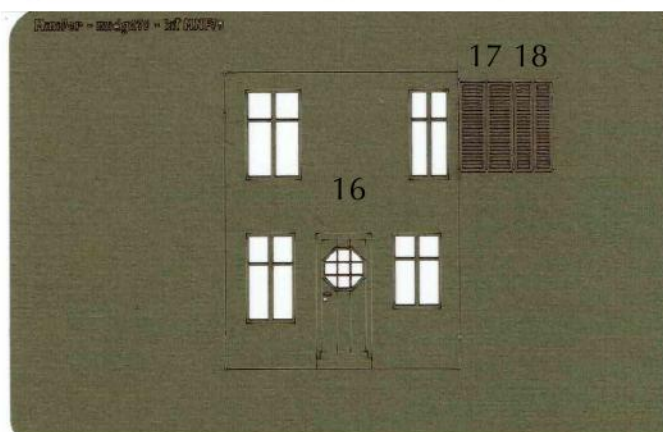
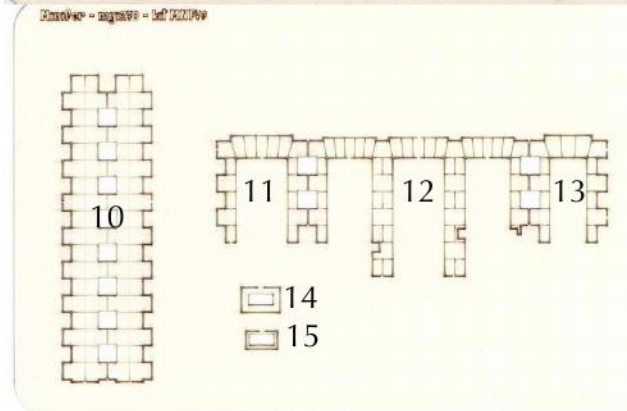
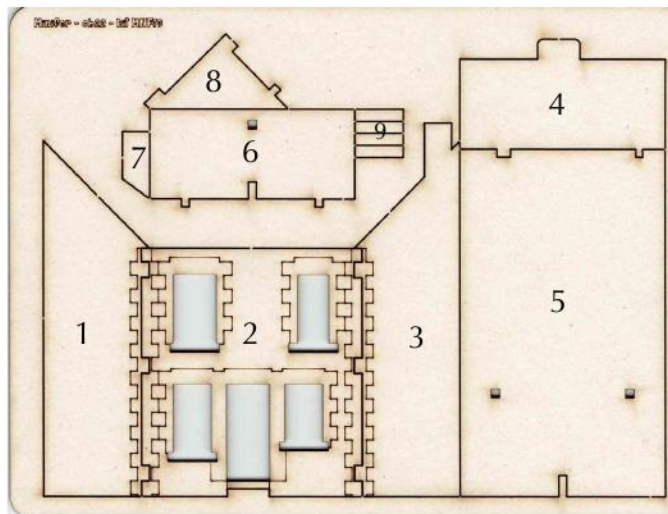

Construction

- 1 Using the foam sponge, paint the walls with Dark Buff Titanium, then paint the window sills, opening surrounds and corner stones in white.

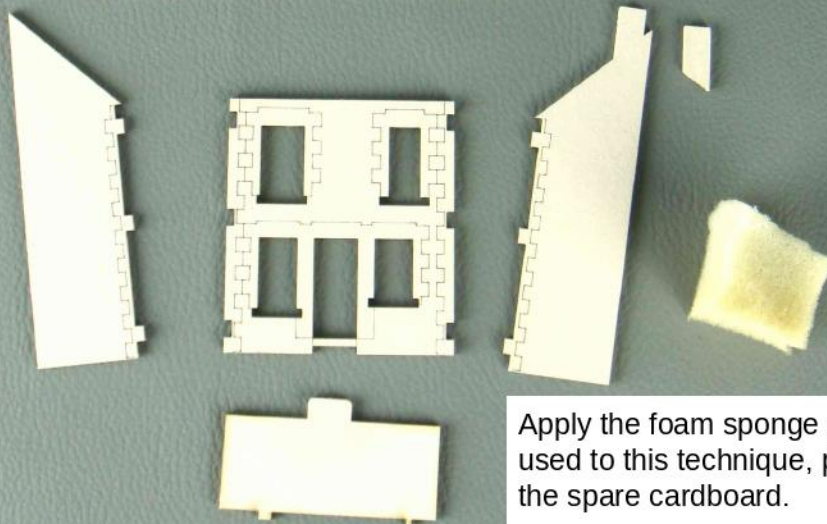
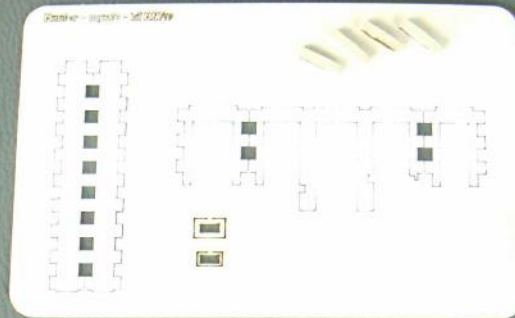

Apply the foam sponge gently. To get used to this technique, practise first on the spare cardboard.

2

Glue pieces 1, 2, 3, 4 and 7 together. You will notice that the doorstep is not centred — this is normal as the door and window frames are not symmetrically placed on the facade. This is what gives this house its charm!

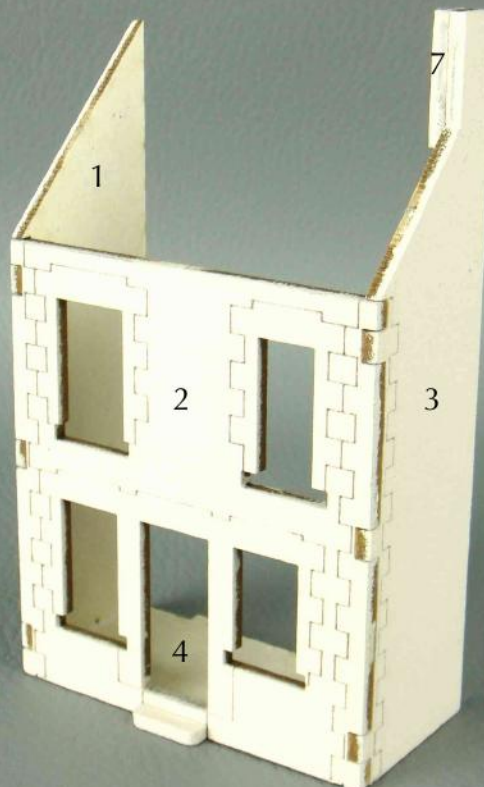

3 Paint the opening surrounds white.

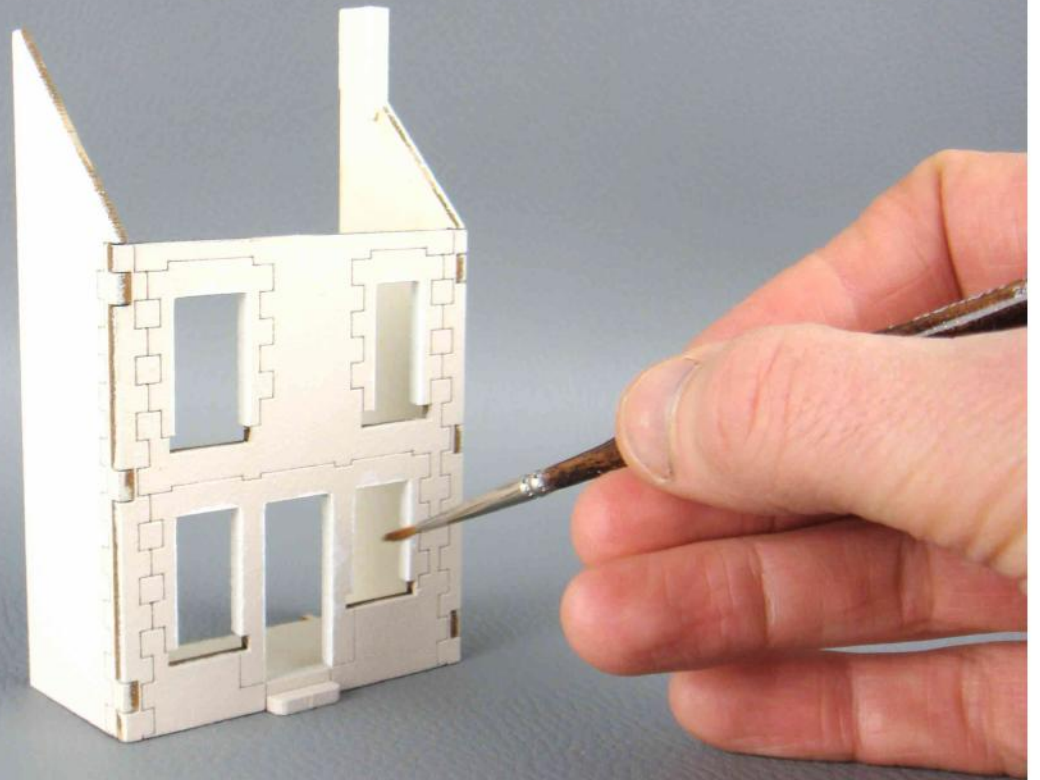

4

Fix the door and window frames inside the house. Don't forget to place a transparent plastic film on the inside to simulate the glass panes.



5 Glue pieces 5, 6 and 8 together.

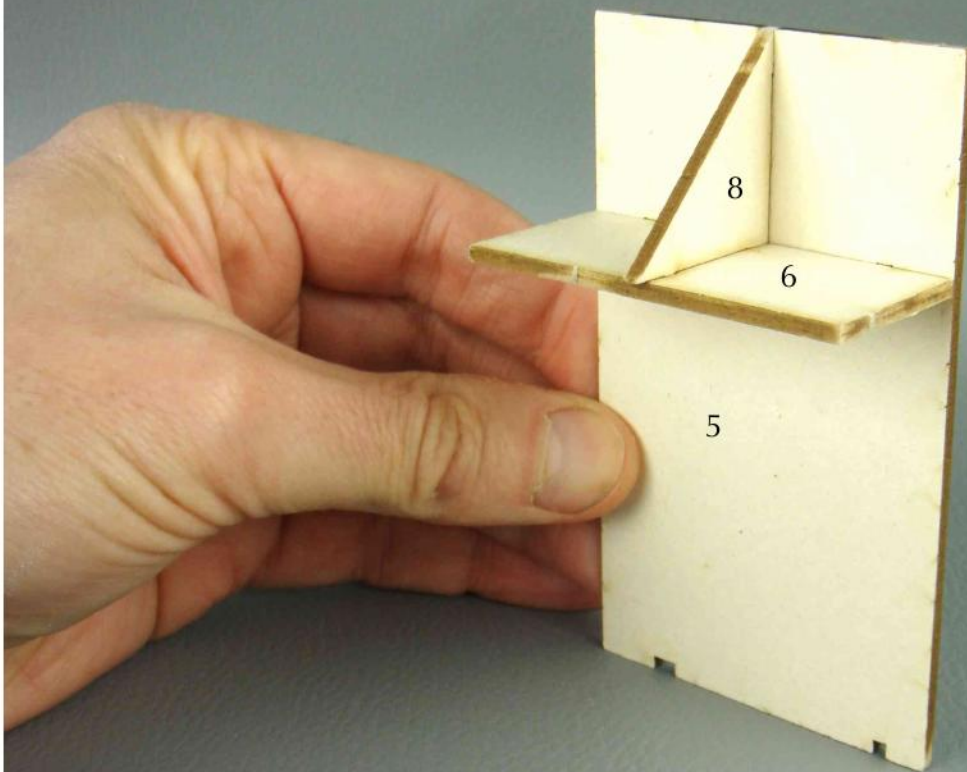

6 Fix the previous elements onto the house.

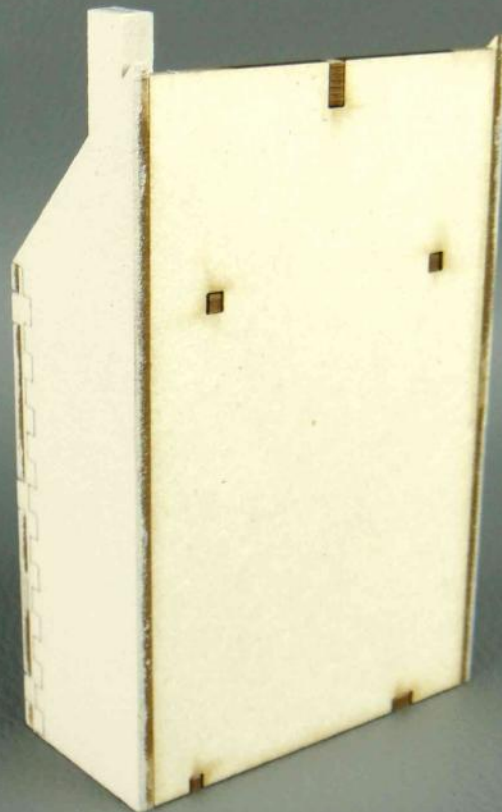

You will obtain the following result:



7

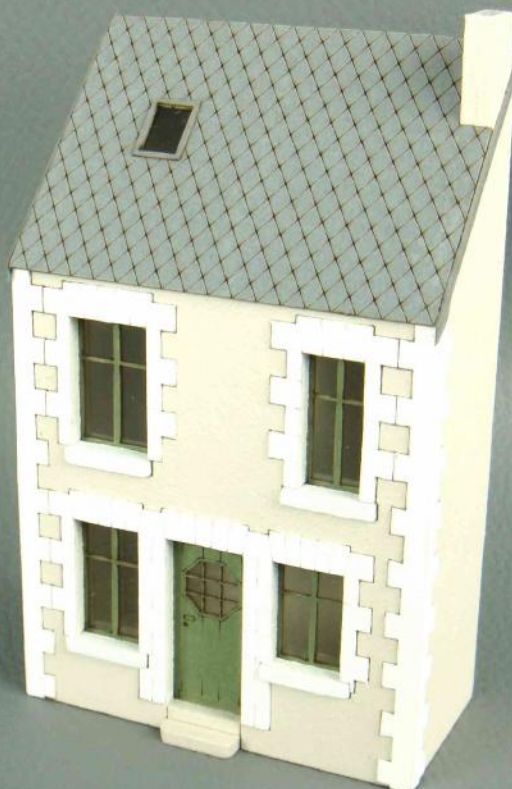

Glue the cladding panels, window sills, roof, skylight surround and edges onto the house. Before fixing the roof, don't forget to glue a transparent plastic film behind the skylight.



8 Using a marker pen, outline the chimney opening in black.



9 Paint the chimney caps with Dark Buff Titanium, then fix them in place.

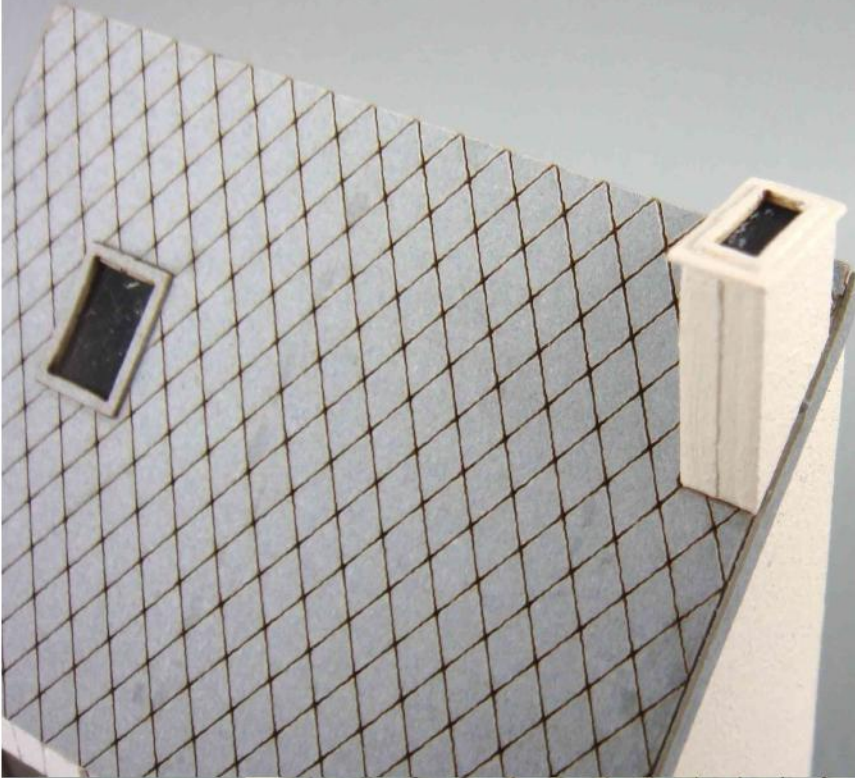

10

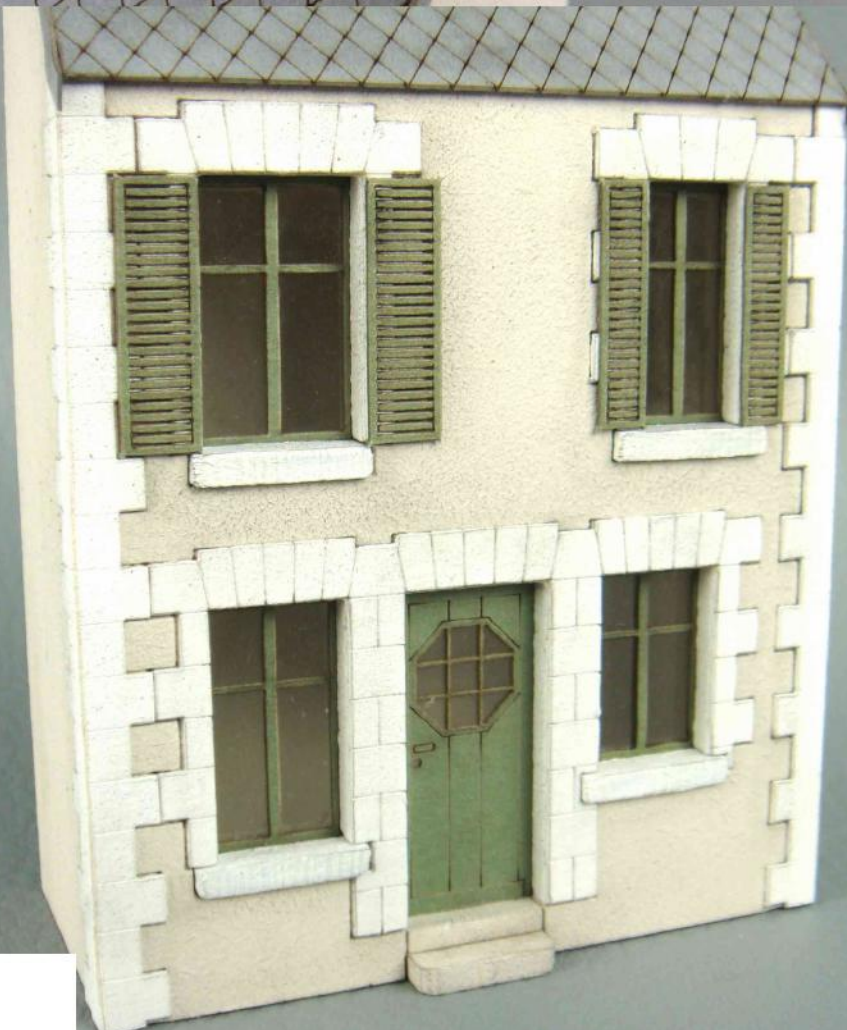

Finally, glue the shutters.

11 Lightly weather the house with black decorating clay.

You are done!

